



195

BRITISH ACADEMY
OF FILM AND TELEVISION ARTS

A Unique Venue For Your Event 2
David Lean Room & Foyer Bar 4
Princess Anne Theatre 6
Run Run Shaw Theatre & Mezzanine 8
The Gallery 10
The Boardroom 12
The 195 Piccadilly Dining Experience 14
About the Academy 16
Contact 17

A Unique Venue For Your Event

195 Piccadilly is the headquarters of the British Academy of Film and Television Arts — the leading British charity dedicated to supporting, developing and promoting the art forms of the moving image, by identifying and rewarding excellence, inspiring practitioners and benefiting the viewing public.

This resplendent building — voted the number one venue of 2008 by readers of *Event* magazine — offers some of the most distinctive corporate entertaining and events opportunities in central London, all supported by exceptional levels of service. 195 Piccadilly is also the private club for Academy members, providing exclusive business and entertaining facilities for those within the Film, Television and Video Games industries.



David Lean Room & Foyer Bar

The generous space offered by the David Lean Room and its adjoining Foyer Bar is perfect for any special occasion, from gala dinners, auctions and weddings to press launches, business conferences and presentations.

Location
First Floor

Dimensions (David Lean Room)

Length 46'4" / 14.12m
Width 41'4" / 12.59m
Area 1,915' / 177.77m
Height 11' / 3.36m

Separating doors betw. DLR & Foyer Bar

Height 9'2" / 2.8m
Width 20'6" / 6.25m

Dimensions (Foyer Bar)

Length 41'10" / 12.76m
Width 26'4" / 8.3m
Area 1,066'2" / 105.91m
Height 11' / 3.36m

Access

Door height 6'6" / 1.98m
Door width 4'1" / 1.25m

Projection

BARCO DP1500 2K resolution video projector
Image any size up to 20' x 9' / 6.1m x 2.74m
HD CAM / DVD / Digibeta / Laptop
50" plasma screens x 4 in DLR
50" plasma screens x 2 in Foyer Bar



HD Playback
Dolby® Digital Camera system
Kodak Digital Cinema System
2 channel stereo

Capacity

Seated dinner 204
Theatre-style 200
Cabaret-style 120
U-Shape 70
Reception 350
Dinner Dance (with Foyer Bar) 180
Classroom-style (with Foyer Bar) 100

Other features

Full screening and PA system
Natural light
Air conditioning
Can accommodate a stage and dancefloor

- Wall mounted electrical socket outlet
- Floor mounted electrical socket outlet
- RJ45 comms link
- (All floor sockets are in floor traps)
- Plasma screen
- Speaker
- Fire Exit



DAVID LEAN ROOM & FOYER BAR



Princess Anne Theatre

This private state-of-the-art cinema offers world-class 35/70mm and digital cinema projection facilities. With seating for 227, the theatre is primarily used for screenings but is ideal for conferences, awards ceremonies and seminars too.

Location

Second Floor

Dimensions

Length 61' / 18.75m
Width 42' / 13.92m
Area 2,562' / 242.25m
Height 20' / 6m

Access

Door height 6'6" / 1.98m
Door width 4'1" / 1.25m

Capacity

227

Projection

BARCO DP1500 2K resolution video projector
35/70mm Cinemacanna projectors x 2
HD CAM / DVD / Digibeta / Laptop
Max image width 34' / 10.36m
Max image height 14'2" / 4.32m

HD Playback

Dolby® Digital Camera system
Dolby® Cinema 3D (advance notice required)
Kodak Digital Cinema System

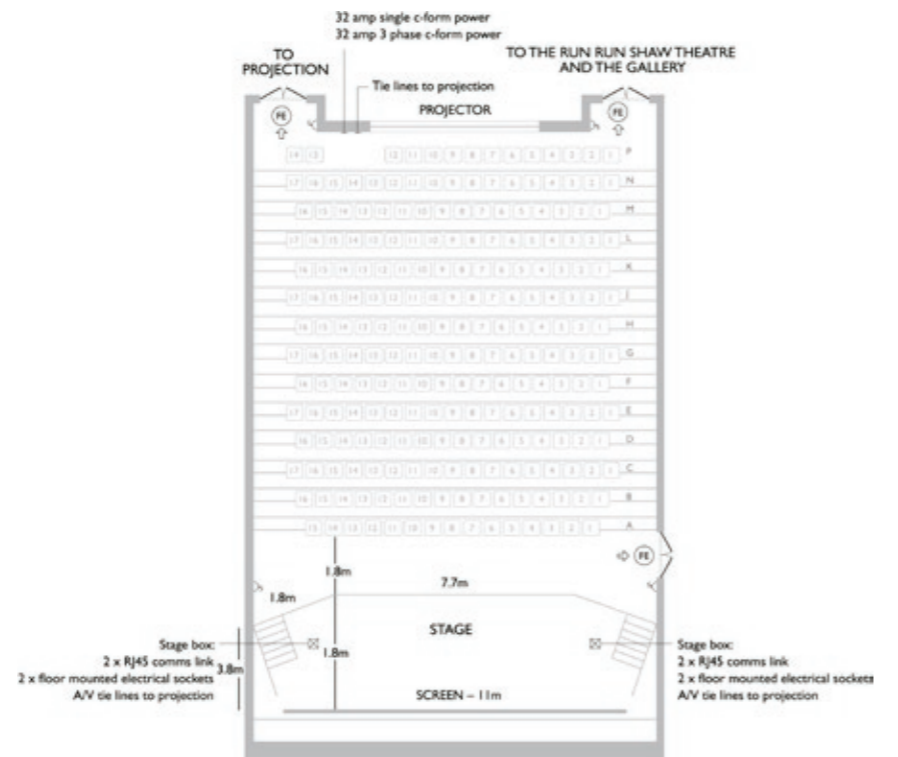

Sound

Dolby CP650 / 6.1 EX
DTS XD10 6.1 ES
35mm 6 track magnetic replay

Other features

Air conditioning
Moving head lights x 4
Multi-coloured screen curtain lights
Multi-coloured handrails
LCD display monitor in lectern (corporate logos)

Stage height - 10.5m

- ⏏ Wall mounted electrical socket outlet
- ⏏ Floor mounted electrical socket outlet
- ⏏ Fire Exit



Run Run Shaw Theatre & Mezzanine

This versatile area offers an intimate screening room that can also be used for presentations, interviews, auditions and board meetings. Sliding soundproof doors give the option of opening it up to the adjoining Mezzanine, creating a larger space that's perfect for a party or pre-screening drinks reception.

Location

Third Floor

Dimensions (Combined)

Length 25' / 8m
Width 18' / 5.5m
Area 486' / 44m
Height 10' / 3m

Access

Door height 6'6" / 1.98m
Door width 2'6" / 0.76m

Projection

BARCO DP1500 2K resolution video projector
HD CAM / DVD / Digibeta / Laptop
Screen size 10' x 5'6" / 3.05m x 1.68m

Sound

DTS XD10P 5.1

Other features

Air conditioning
Natural light (Mezzanine)

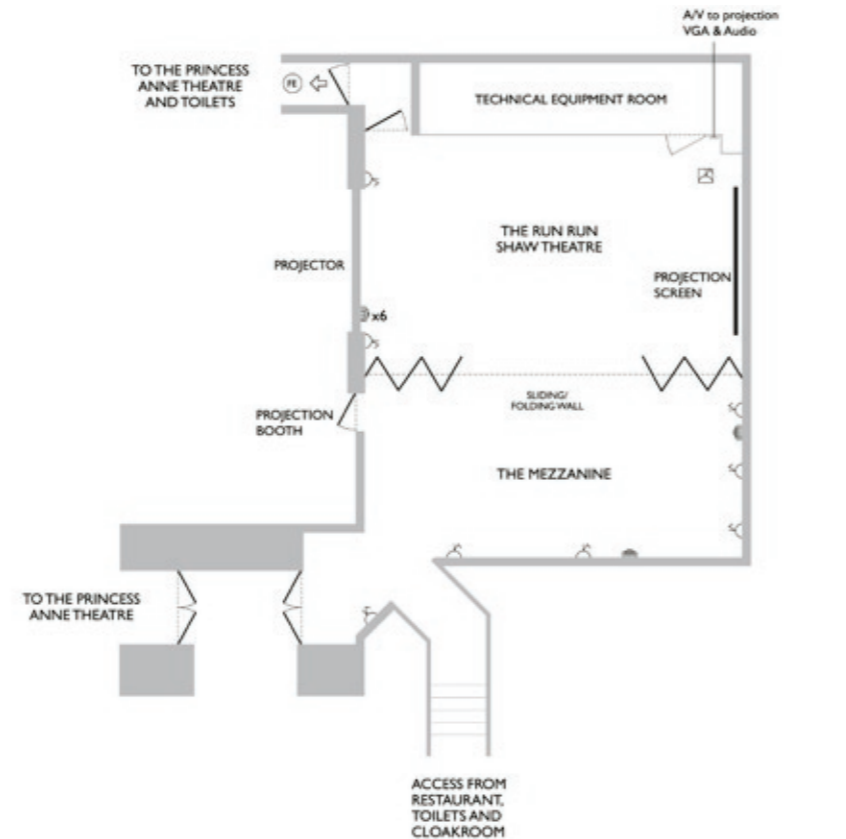

Capacity (Run Run Shaw)

Theatre-style 40
Boardroom/Lunch/Dinner 30
Cabaret-style 20

Capacity (RRS & Mezzanine)

Reception 140
Boardroom-style 60
Theatre-style 60
Cabaret-style 40

- ⊗ Wall mounted electrical socket outlet
- ⊗ Floor mounted electrical socket outlet
- ⊗ RJ45 comms link
- ⊗ Fire Exit



The Gallery

A semi-private, glass-walled space, The Gallery is perfect for smaller parties or business meetings. It can be hired together with the Run Run Shaw Theatre and Mezzanine, providing ideal break-out space.

Location

Third Floor

Dimensions

Length 18'6" / 5.63m
Width 13'5" / 4.1m
Area 234'21" / 23.09m
Height 8' / 2.45m

Projection

50" plasma screen

Capacity

Boardroom/Dinner 25
Theatre-style 30
Reception 40

Other features

Air conditioning
Natural light

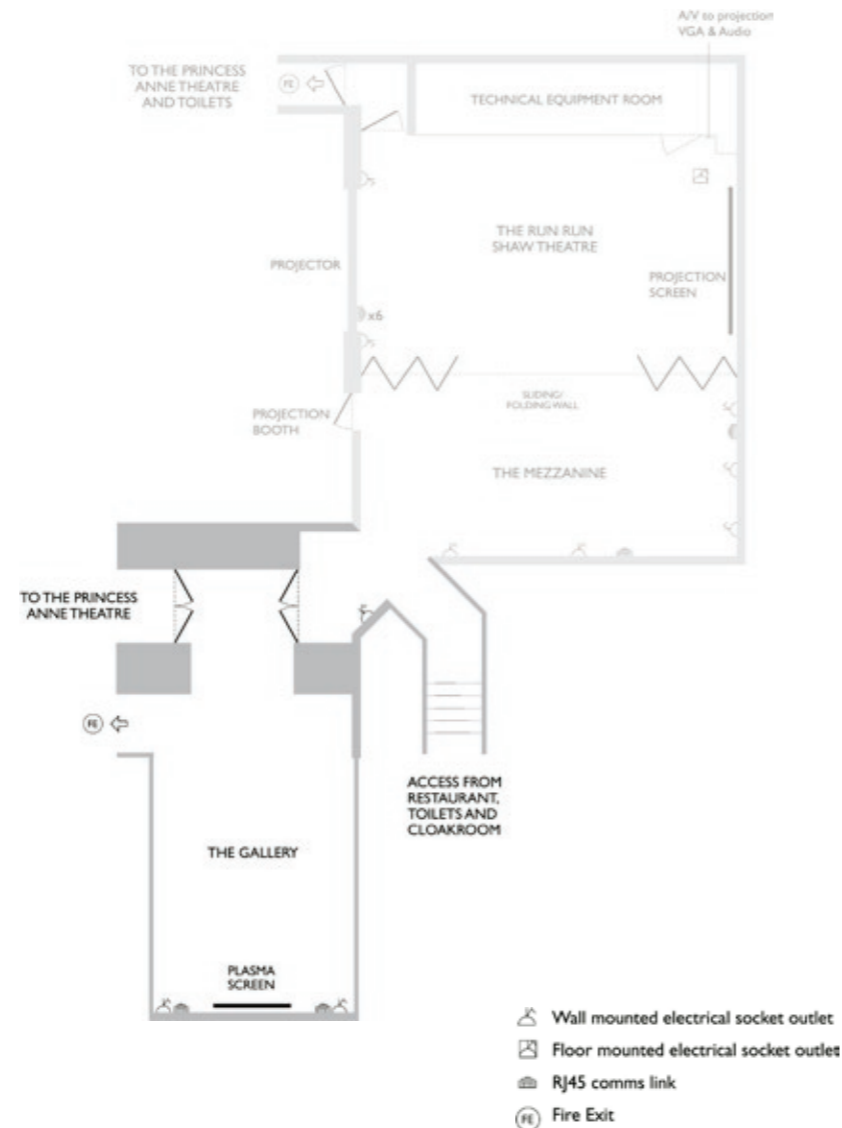

The Boardroom

A bright, flexible and private meeting space, The Boardroom is perfect for smaller presentations, interviews, training sessions and meetings.

Location

Third Floor

Dimensions

Length 18' / 5.5m
Width 20' / 6m
Area 360' / 33m
Height 8' / 2.45m

Access

Door height 6'6" / 1.98m
Door width 2'5" / 0.74m

Projection

50" plasma screen



Capacity

Boardroom/Dinner 20

Other features

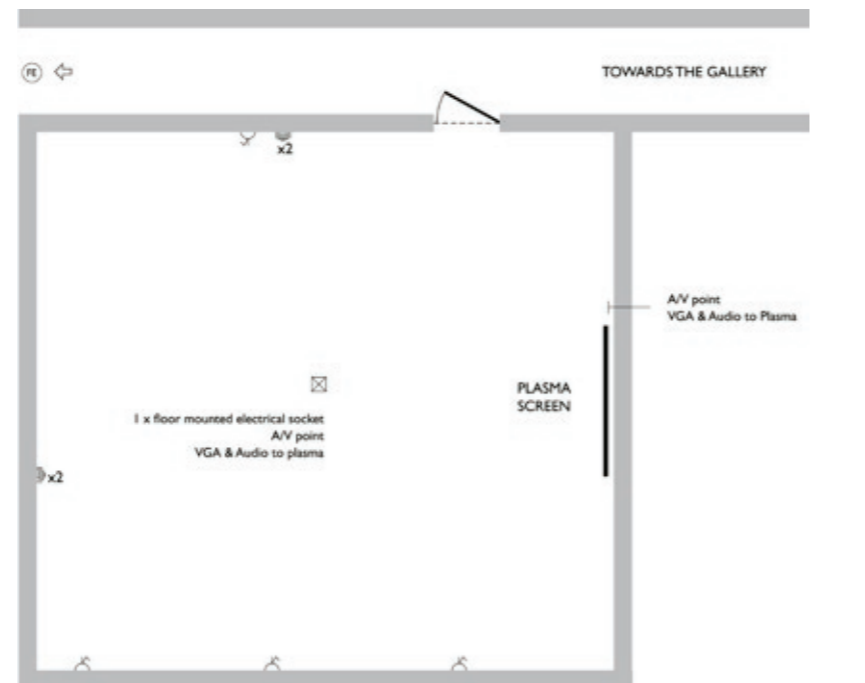
Air conditioning
Natural light



-  Wall mounted electrical socket outlet
-  RJ45 comms link
-  Fire Exit



The 195 Piccadilly Dining Experience

Whether a buffet lunch, hot canapés or an elegant five-course meal, our dedicated team offers a wealth of experience in large-scale catering and fine gourmet dining.

View the latest seasonal menu at www.195piccadilly.co.uk.



About the Academy

The British Film Academy, as it was first known, formed on 16 April 1947 when its founding members met at the Hyde Park Hotel under the Chairmanship of David Lean. Their fundamental aim was “to recognise those who had contributed outstanding creative work towards the advancement of British Film.”

Eleven years later, the Academy merged with the Guild of Television Producers and Directors to become the Society of Film and Television Arts. David Lean donated royalties from *The Bridge On The River Kwai* and *Doctor Zhivago* to the Society, which served as an invaluable source of working capital in its early years.

In the early '70s, Her Majesty The Queen gifted the royalties from Richard Cawston's *Royal Family* documentary to the Society, enabling it to move from its office suite in Great Portland Street to 195 Piccadilly, which was converted to house two preview theatres and a meeting place for members.

In 1976, Her Majesty The Queen, HRH The Duke of Edinburgh, HRH The Princess Royal and Lord Mountbatten opened these new headquarters at 195 Piccadilly and the Society officially became the British Academy of Film and Television Arts.



For more information on 195 Piccadilly or to arrange a viewing, please contact:

195 Piccadilly
London W1J 9LN

t +44 (0)20 7292 5800

e events@195piccadilly.co.uk

w www.195piccadilly.co.uk



195 Piccadilly imagery

Alan Russell
Tricia de Courcy Ling

Awards imagery

Greg Williams
Charlie Gray
Brian Ritchie



