

Run Run Shaw Theatre & Gallery: Features

FLOOR LEVEL 3rd

DIMENSIONS Run Run Shaw

Length 25' / 8m

Width 18' / 5.5m

Area 486' / 44m

Max Height 10' / 3m

Min Height 10' / 3m

Stage Dimensions

16'/4.8m x 4'/1.21m (available to hire)

DIMENSIONS Gallery

Length 18'6" / 5.63m

Width 13'5" / 4.1m

Area 234'21" / 23.09m

Max Height 8' / 2.45m

Min Height 8' / 2.45m

PROJECTOR Run Run Shaw Theatre

(SDI, HDS DI, RGB, Comp Video)

BARCO G5 video/data projector

Image projection size

Max 10' / 3.07m width

Min 5' / 1.52m width

CAPACITY

Theatre RRS 35; Gallery 35

Classroom RRS 20; Gallery 20

Boardroom RRS 30; Gallery 30

U-shape 20 (RRS only)

Lunch/Dinner RRS 25; Gallery 35

Reception RRS 35; Gallery 35

Minimum Gallery 30/35

LIGHTING

Tungsten/Flourescent RRS Tungsten; Gallery both

Controls in Room Yes

Dimmers Yes

Windows No

SOUND

Restricted Sound System fitted to Gallery
(no PA system)

POWER

No of 13 amp sockets RRS 8 on the back wall, 1
x 4way extension from 13A at front; Gallery 6

3-phase available RRS Yes; Gallery No

Phone sockets RRS 12; Gallery 6

Phone Lines RRS 12; Gallery 6 (17 available at
one time in the whole building)

ISDN Lines 6 available at one time in the whole
building

ACCESS RRS

Door Height 6'6" / 1.98m

Door Width 2'6" / 0.76m

ACCESS FOYER BAR

No door



Run Run Shaw Theatre & Gallery

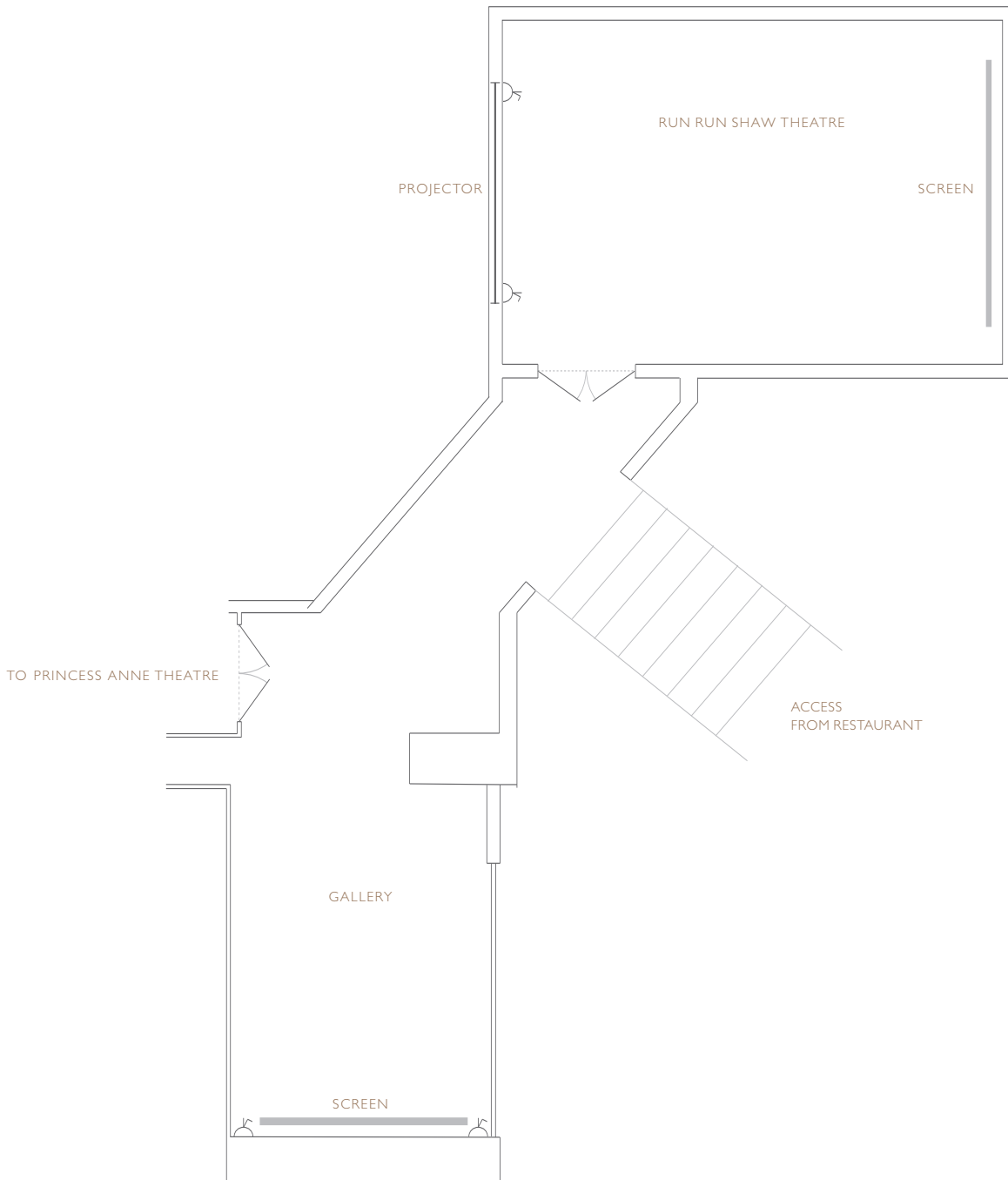

Wall mounted electrical socket outlet